

LABORATORI D'ENVOL BHL7-22  
 Flat area (m<sup>2</sup>) : 22.00  
 Flat span (m) : 10.44  
 Flat aspect ratio : 4.96  
 Cells number : 33

1-1 PLANFORM AND VAULT

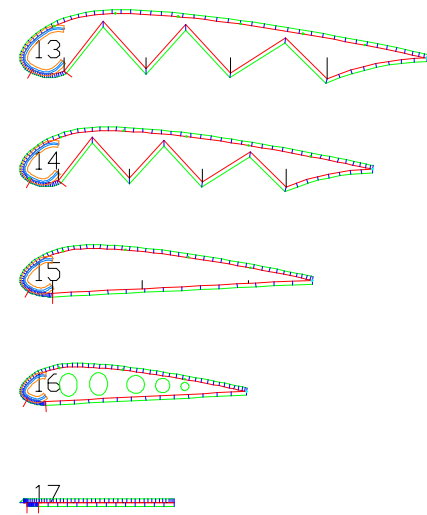

Leading edge

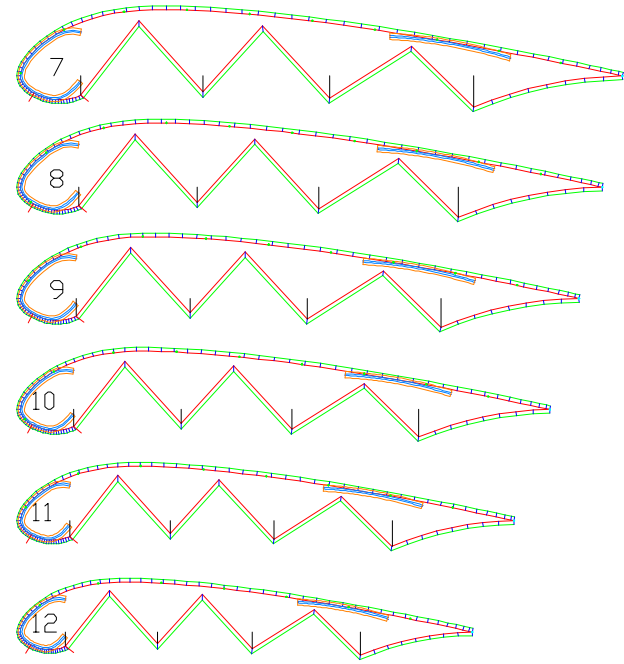
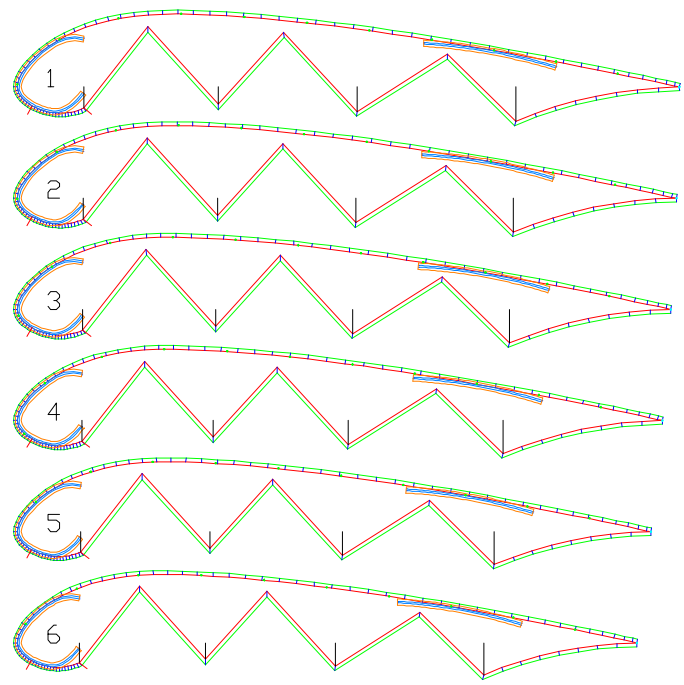
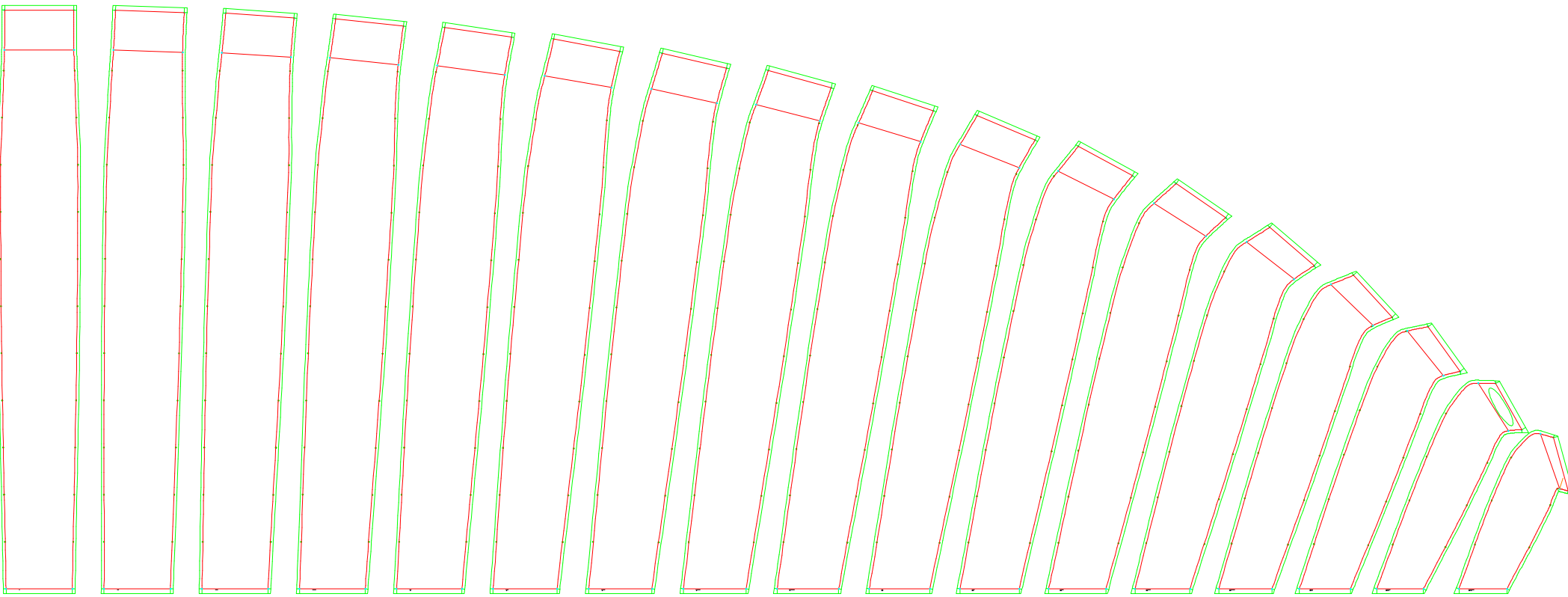

Trailing edge

1-3 EXTRADOS PANELS

Trailing edge

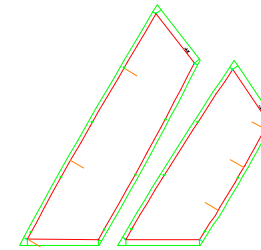

Leading edge

2-3 INTRADOS PANELS

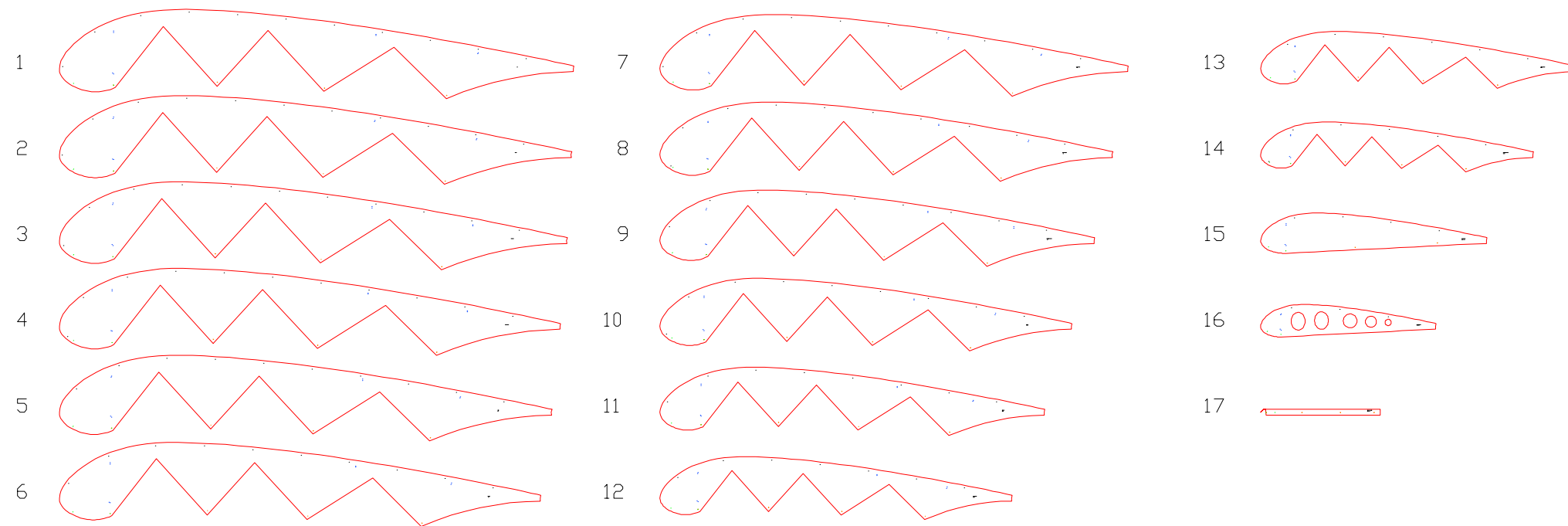

1-4 RIBS (FOR CUTTING TABLE)

Leading edge

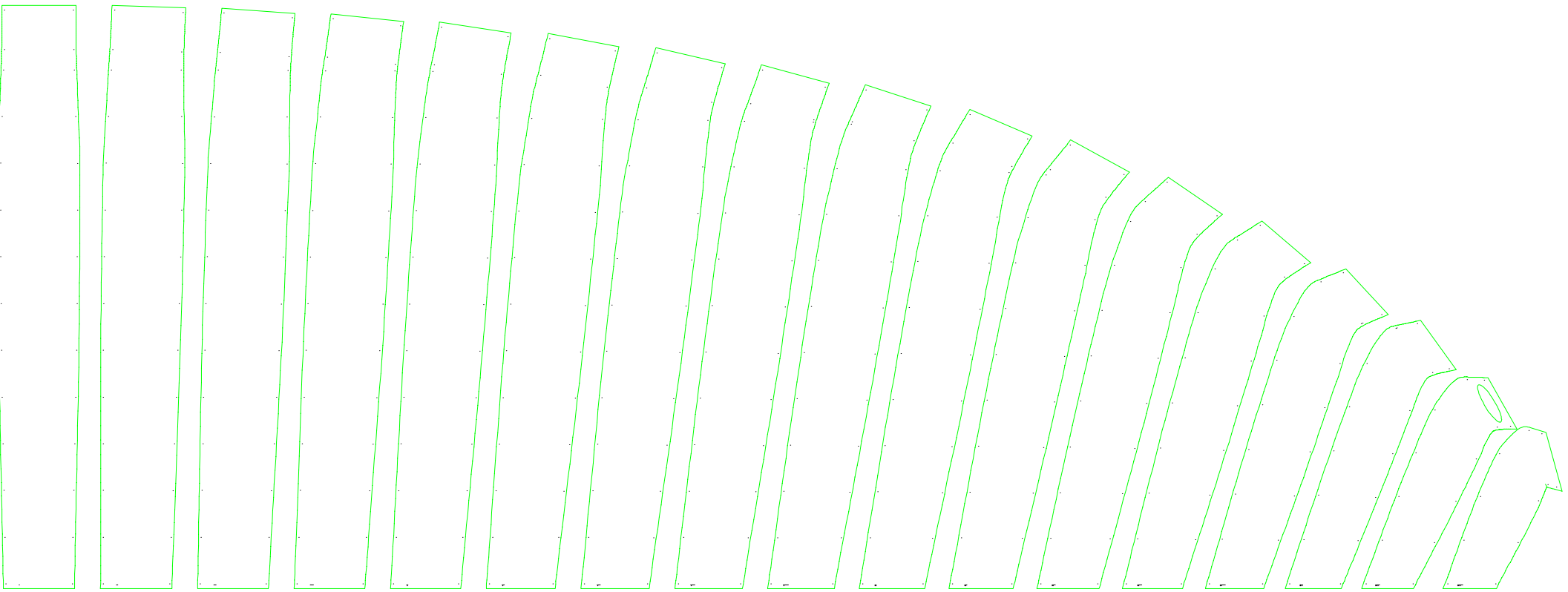

Trailing edge

1-5 EXTRADOS PANELS (FOR CUTTING TABLE)

Trailing edge

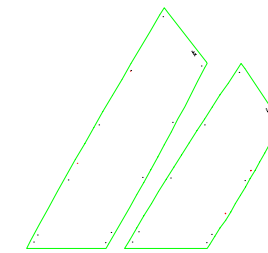

Leading edge

2-5 INTRADOS PANELS (FOR CUTTING TABLE)

0 1  
[ ]

4 5  
[ ]

9 10  
[ ]



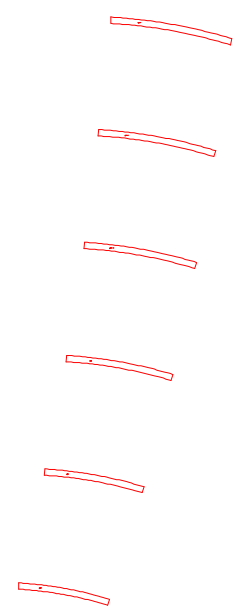
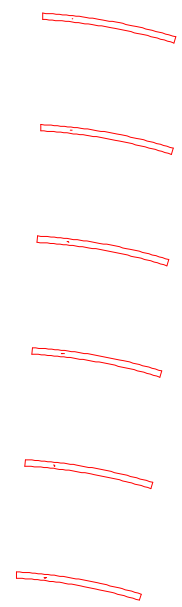

List of nylon rods (bloc 1)

Group	1	
Jonc	1	69.2
Jonc	2	68.9
Jonc	3	68.3
Jonc	4	67.4
Jonc	5	66.3
Jonc	6	64.8
Jonc	7	63.0
Jonc	8	60.9
Jonc	9	58.4
Jonc	10	55.4
Jonc	11	51.6
Jonc	12	47.2
Jonc	13	42.2
Jonc	14	36.5
Jonc	15	29.6
Jonc	16	22.8

List of nylon rods (bloc 2)

Group	1	
Jonc	1	53.4
Jonc	2	53.2
Jonc	3	52.7
Jonc	4	52.0
Jonc	5	51.1
Jonc	6	50.0
Jonc	7	48.6
Jonc	8	47.0
Jonc	9	45.1
Jonc	10	42.7
Jonc	11	39.8
Jonc	12	36.4

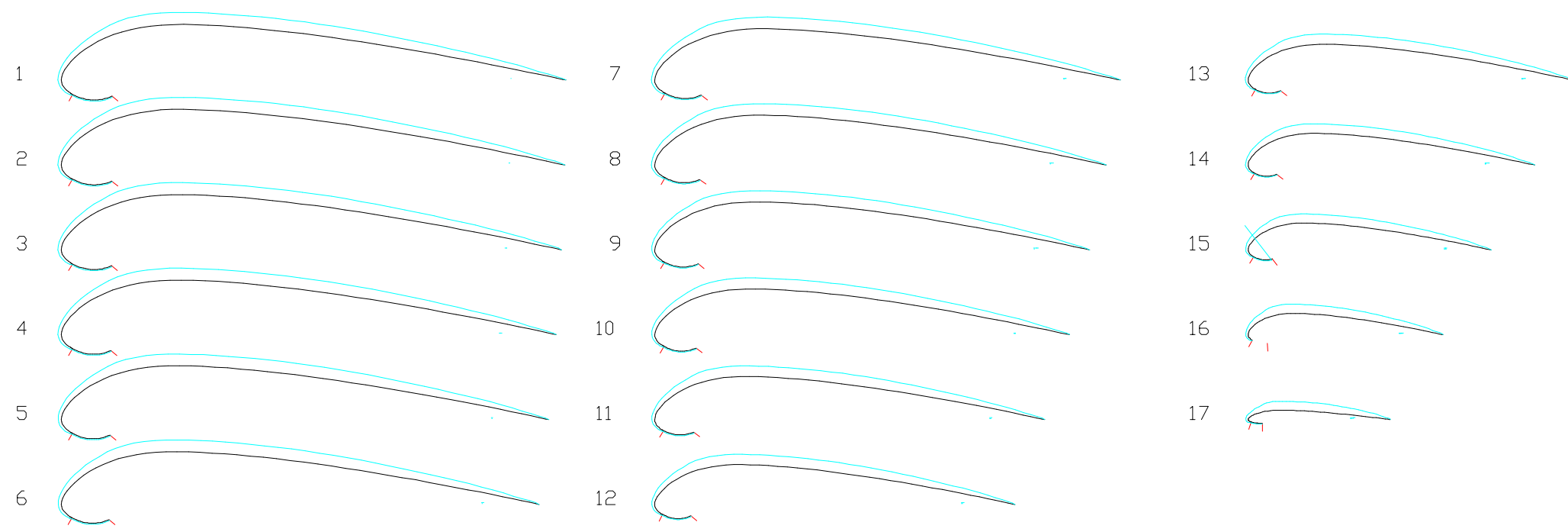

1-8 MIDDLE AND MIDDLE OVALIZED AIRFOILS

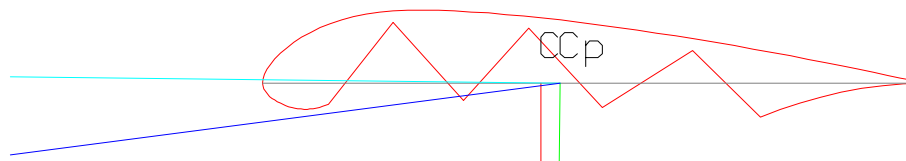

calage= 42.00  
 center pressure= 45.00  
 glide ratio= 7.00  
 glide angle= 8.13  
 angle of attack= 7.47  
 assiette= 0.66

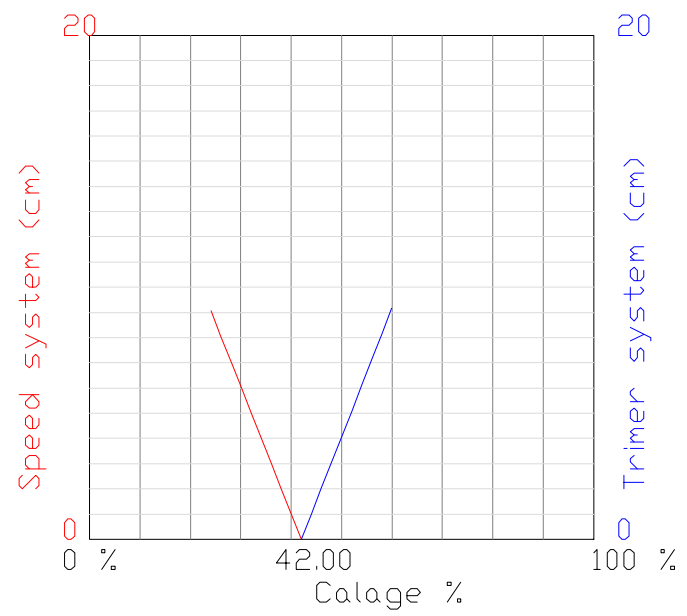

pilot

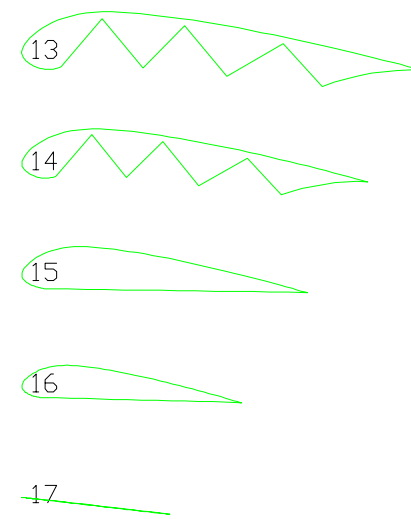
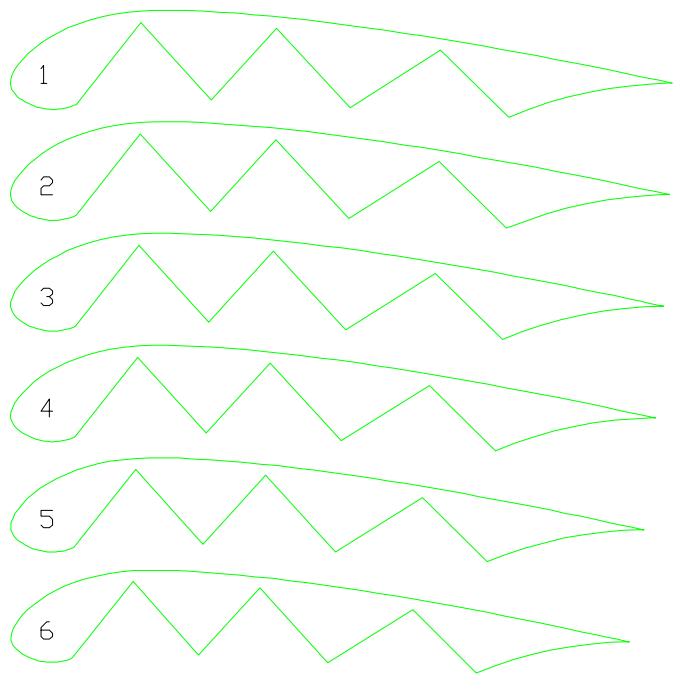

2-2 RIBS WASHIN ANGLE

Line - Label - Length

1	1A1	47.0
2	2A1	342.9
3	2A2	335.8
4	2A3	316.9
5	3A1	185.9
6	3A2	185.9
7	3A3	185.9
8	3A4	185.9
9	3A5	185.9
10	3A6	185.9
11	4A1	106.1
12	4A2	102.0
13	4A3	100.4
14	4A4	101.7
15	4A5	108.8
16	4A6	104.3
17	4A7	104.1
18	4A8	99.5
19	4A9	104.1
20	4A10	117.9
21	4A11	109.0
22	4A12	107.2
23	4A13	101.8
24	4A14	95.2
25	4A15	93.9

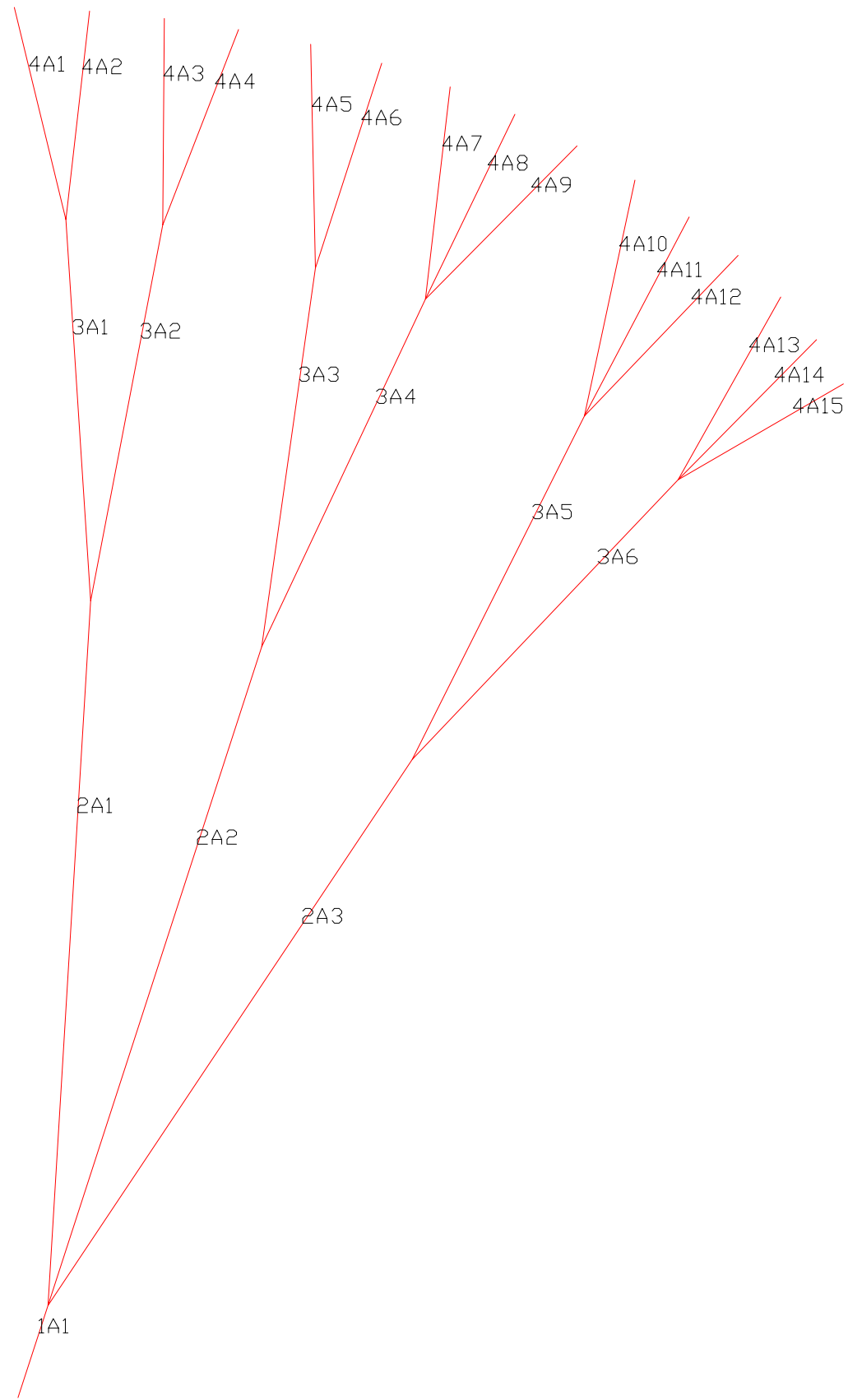

3-2 LINES A

Line - Label - Length

26	1B1	47.0
27	2B1	374.9
28	2B2	364.8
29	2B3	336.9
30	2B4	421.0
31	3B1	185.9
32	3B2	185.9
33	3B3	185.9
34	3B4	185.9
35	3B5	185.9
36	3B6	185.9
37	3A17	146.1
38	3B17	146.7
39	3C17	149.9
40	3D17	154.7
41	4B1	71.9
42	4B2	67.4
43	4B3	65.9
44	4B4	67.5
45	4B5	77.8
46	4B6	73.0
47	4B7	73.1
48	4B8	68.5
49	4B9	74.1
50	4B10	96.1
51	4B11	87.4
52	4B12	86.1
53	4B13	80.9
54	4B14	74.9
55	4B15	77.3

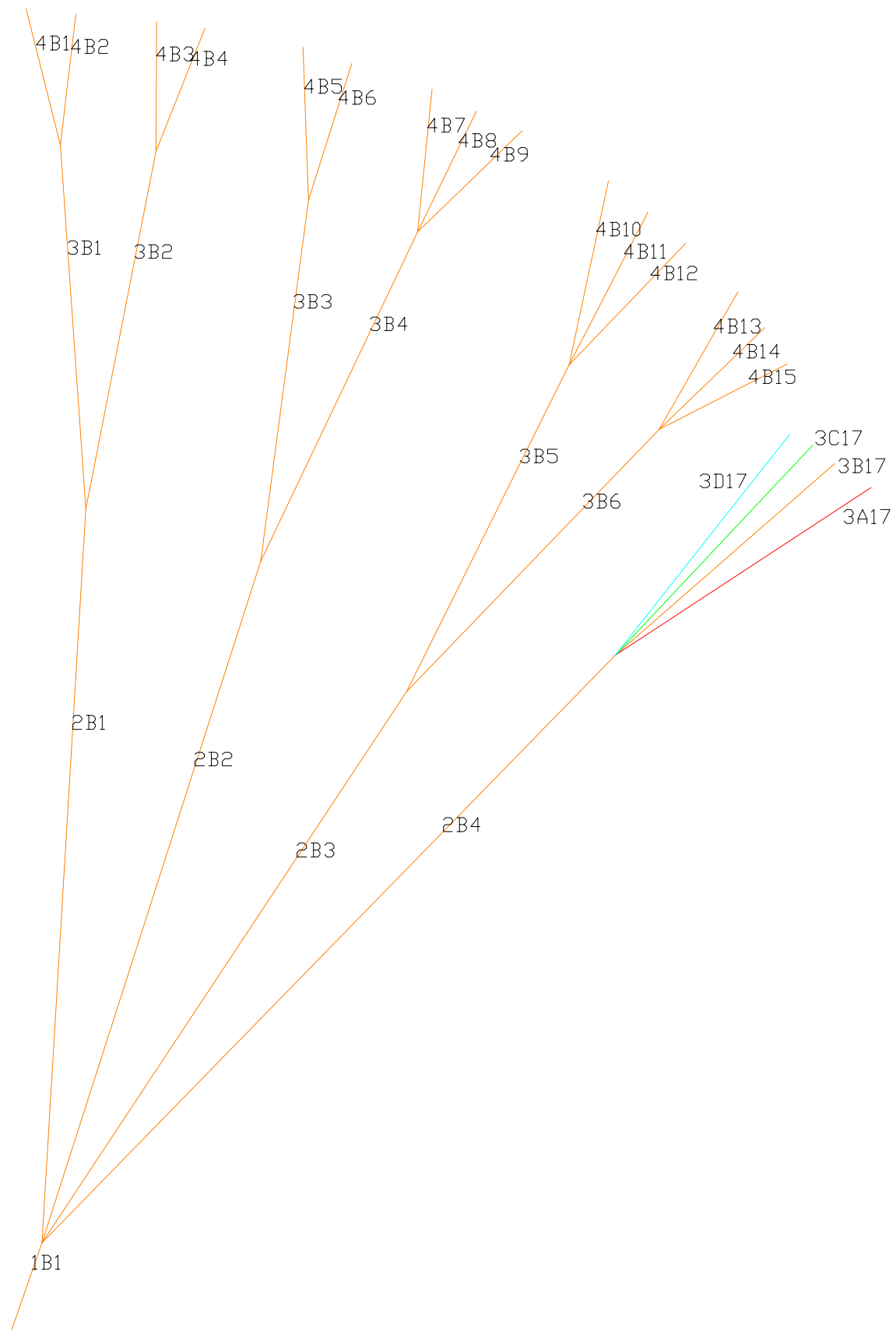

3-3 LINES B

Line - Label - Length

56	1C1	47.0
57	2C1	365.8
58	2C2	356.8
59	2C3	335.9
60	3C1	185.9
61	3C2	185.9
62	3D3	186.0
63	3D4	186.0
64	3C5	185.9
65	3C6	185.9
66	3D7	186.0
67	3D8	185.9
68	3C9	185.9
69	3C10	186.0
70	3D11	186.0
71	3C12	186.0
72	4C1	77.5
73	4C2	73.4
74	4C3	72.0
75	4C4	73.5
76	4D1	80.2
77	4D2	76.0
78	4D3	74.6
79	4D4	75.6
80	4C5	82.7
81	4C6	78.3
82	4C7	78.5
83	4C8	74.3
84	4C9	79.4
85	4D5	85.2
86	4D6	80.5
87	4D7	80.7
88	4D8	75.9
89	4D9	80.3
90	4C10	94.5
91	4C11	86.6
92	4C12	85.8
93	4C13	79.8
94	4C14	77.1
95	4D10	96.2
96	4D11	87.9
97	4D12	86.7
98	4D13	83.0
99	4D14	77.3
100	4C15	82.5

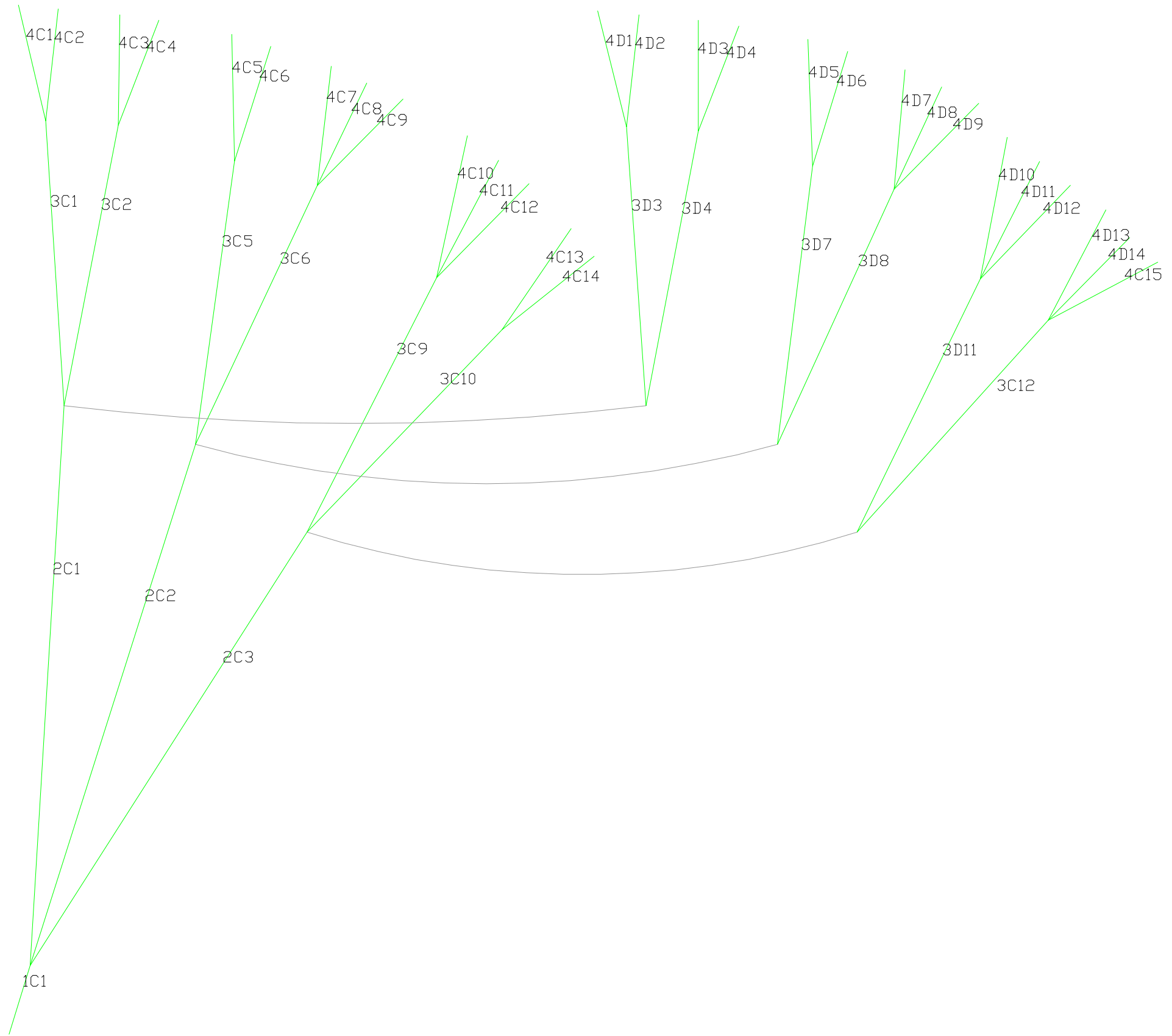

3-4 LINES C

Line - Label - Length

101	1F1	282.0
102	2F1	225.0
103	2F2	193.0
104	2F3	240.0
105	3F1	78.0
106	3F2	78.0
107	3F3	78.0
108	3F4	78.0
109	3F12	115.0
110	3F13	105.9
111	3F14	101.6
112	3F15	102.4
113	3F16	105.9
114	4F2	99.4
115	4F3	86.1
116	4F4	77.8
117	4F5	75.1
118	4F6	107.0
119	4F7	93.1
120	4F8	87.9
121	4F9	84.4
122	4F10	82.0
123	4F11	89.4

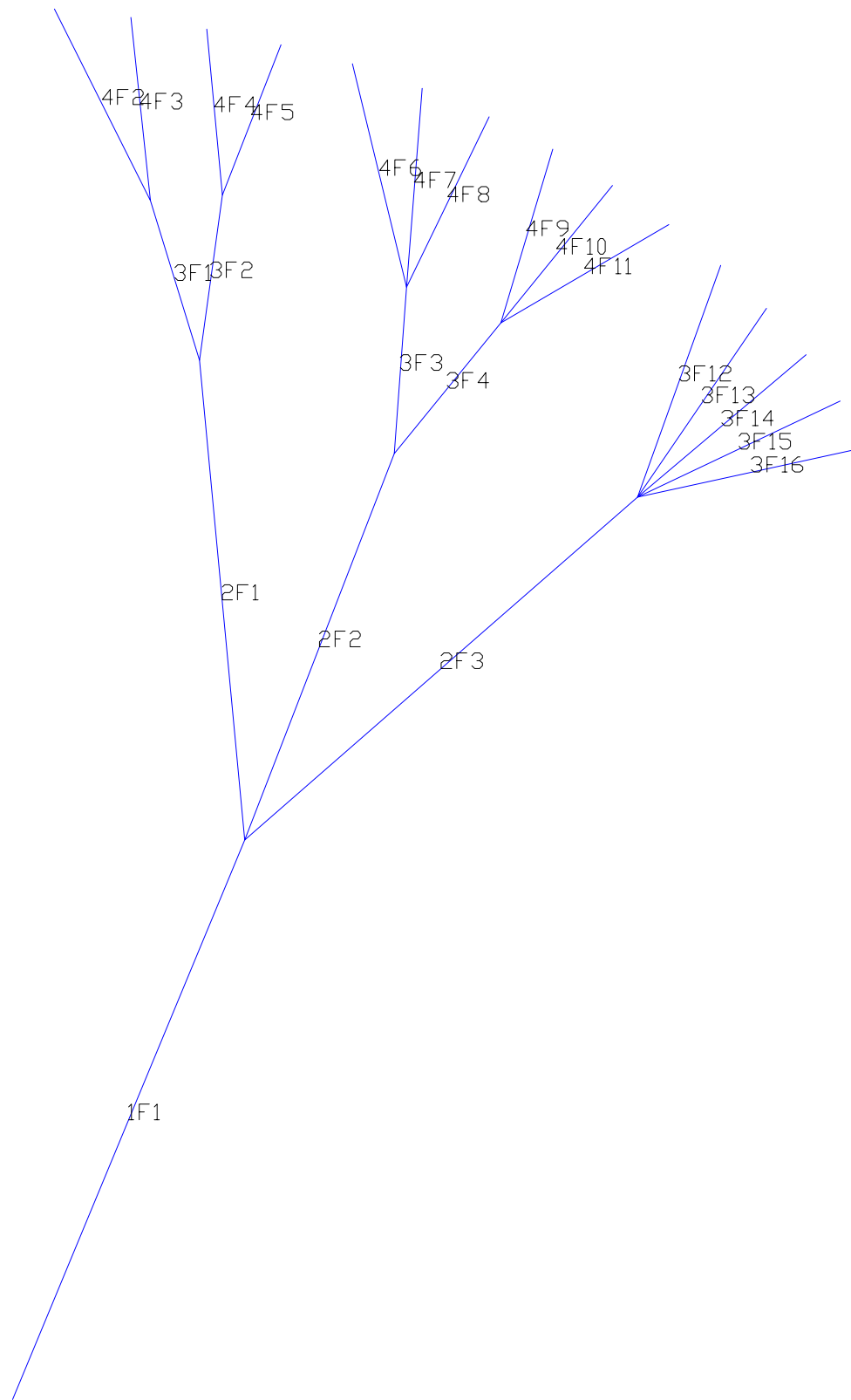

4-5 BRAKES



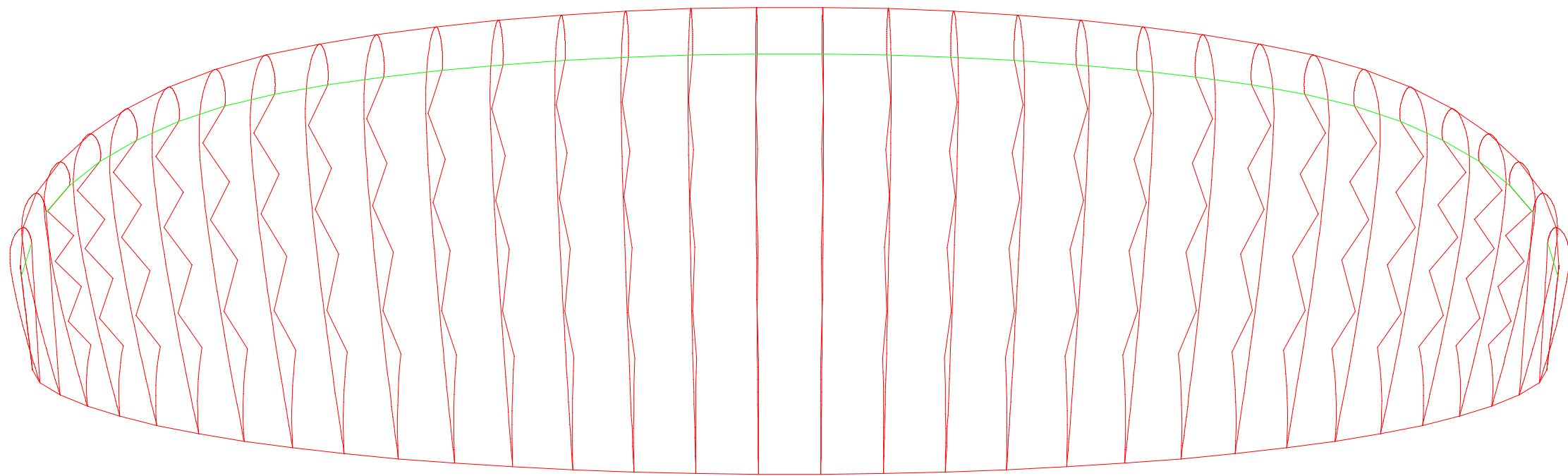

3-1 UPPER VIEW

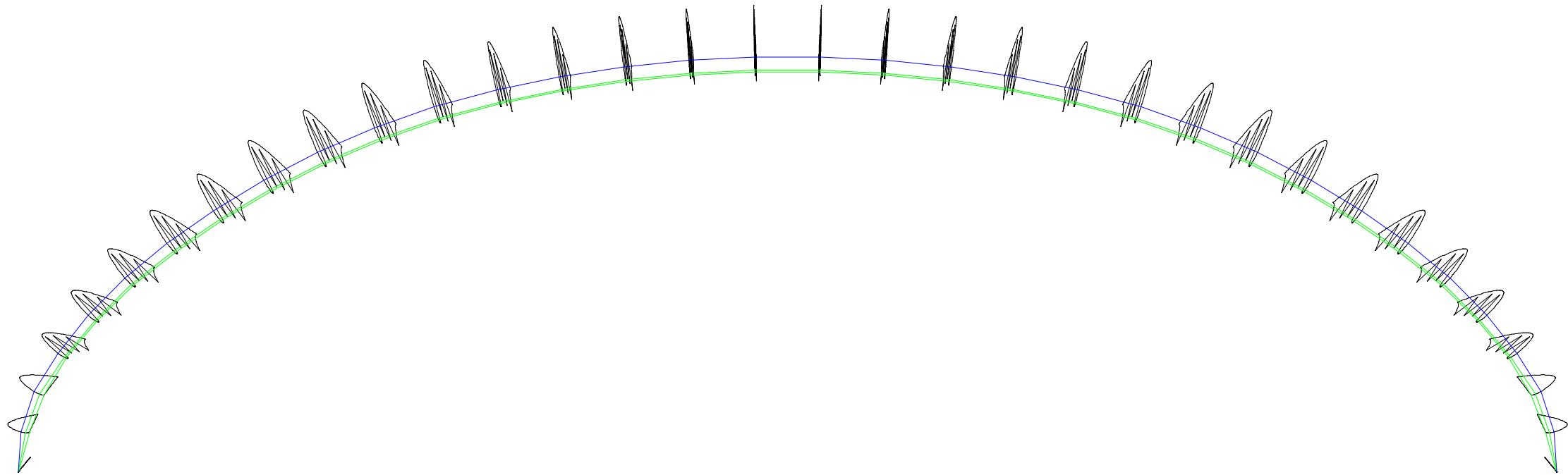

4-1 VAULT VIEW

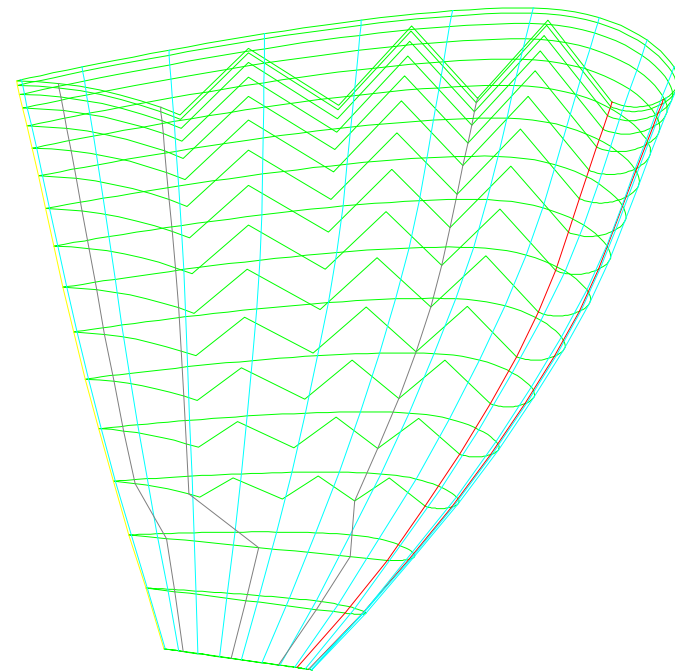

4-2 LATERAL VIEW

## PLANS GENERAL NOTES

- 1-1: Planform and vault view (informative)
- 1-2: Ribs for plotter, one side
- 1-3: Extradados panels for plotter, one side
- 1-4: Ribs for laser cutting, one side. Units cm
- 1-5: Extradados for laser cutting, one side. Units cm
- 1-6: Middle unloaded ribs for laser cutting, one side Units cm
- 1-7: Rods pockets and nylons lengths, mylars
- 1-8: Intermediate and ovalized airfoils
  
- 2-1: Calage estimation, speed and trim systems
- 2-2: Ribs printed with washin angle (informative)
- 2-3: Intrados panels for plotter, one side
- 2-4: Mini-ribs horizontal and diagonal
- 2-5: Intrados for laser cutting, one side
- 2-6: Full diagonal ribs laser, one side
- 2-7: Free
  
- 3-1: Upper view 3D (informative)
- 3-2: Lines A
- 3-3: Lines B
- 3-4: Lines C
- 3-5: Lines D
- 3-6: V-rib type-6
- 3-7: Free
  
- 4-1: Vault view (informative)
- 4-2: Lateral view (informative)
- 4-3: Brake distribution (informative)
- 4-4: Free
- 4-5: Brake lines
- 4-6: Free
- 4-7: General notes

## UNITS

Main units are centimeters. Scale x10 to use in mm

## WIDTHS FOR SEWING AND OFFSETS

- Lateral width in extradados (mm): 15.00
- Width in leading edge ex (mm): 25.00
- Width in trailing edge ex (mm): 25.00
- Lateral width in intrados (mm): 15.00
- Width in leading edge in (mm): 25.00
- Width in trailing edge in (mm): 25.00
- Lateral width in ribs (mm): 15.00
- Lateral width in V-ribs (mm): 15.00
- General offset lateral points (mm): 1.20
  
- Distance between equidistant points (cm): 25.00

## "ROMAN" NUMBERS CODIFICATION

Numbering panels, ribs, mini-ribs, V-ribs

- Number 1 = .....
- Number 2 = .....
- Number 3 = .....
- Number 4 = .....
- Number 5 = .....
- Number 6 = .....
- Number 7 = .....
- Number 8 = .....
- Number 9 = .....
- Number 10 = .....
- Number 11 = .....
- Number 12 = .....
- Number 13 = .....
- Number 14 = .....
- Number 15 = .....
- Number 16 = .....
- Number 17 = .....